



Utah High School Activities Association 2014

1A-2A-3A-4A-5A

State Wrestling Championships

Maverik Center, West Valley City, Utah

4A/5A February 13,14,15

1A/2A/3A February 14-15



Tournament Information

The Utah High School Activities Association and Les Schwab Tires are proud to present the 2014 State Wrestling Championships at the Maverik Center in West Valley City. Be sure to read all of the information so as not to be disappointed or surprised on the day of the tournament. **Please be sure to inform your wrestlers, parents and other fans of the following:**

Entries from the Region and Divisional Tournaments

State qualifiers from Region/Division Tournaments are to be entered in the State Tournament by the directors of those tournaments. Entries **MUST** be submitted by midnight the last day of the qualifying tournament. **First and last names must be included as well as year in school, last year's state place and this season's varsity record. This information must be provided by coaches when they enter wrestlers in the Region/Division Tournament.** Wrestlers will be entered in the state tournament by the Region/Divisional Tournament director. Regions/Divisions not using Trackwrestling tournament software should contact Bart Thompson at the UHSAA office (801-566-0681 thompson@uhsaa.org) well in advance of their tournaments for instructions on entering qualifiers in the state tournament.

Region/Division Responsibility to Check Compliance with Weight Management Rules

The NWCA Alpha-Master sheets and individual weight-loss plans must be checked carefully at the Region/Division Tournaments to ensure that each wrestler is competing at a legal weight. Wrestlers who qualify from region/division at a weight class for which they are not eligible to compete will be disqualified from the State Tournament and regions/divisions and schools will be subject to penalty. Schools/coaches attempting to enter a wrestler in a weight class for which they are not eligible will be subject to discipline as well. Please work to avoid problems with this that could occur after region/division by carefully checking each wrestler prior to the region/division tournament.

Region/Division Responsibility for Checking Physician Clearance on Low Body Fat Wrestlers

Wrestlers who require physician's clearance for low body fat should have their clearance recorded on the Alpha-Master prior to competing. Clearance forms should have been submitted to the UHSAA by fax at (801)566-0633, by e-mail, or by regular mail. **Coaches, please check the Alpha-Master** to assure that those who need clearance have it and that it is recorded on the Alpha-Master prior to the region/division seeding meeting to avoid problems. Wrestlers must have at least one legal weigh-in after a legal body fat test and prior to weighing in for any post-season tournament. The weigh-in for a post-season tournament does not fulfill this requirement.

Passes/Tickets Required by All

No one will be admitted without a ticket or pass. Schools are reminded to secure tickets for cheerleaders, bus drivers, managers etc. as they will not be admitted without a ticket.

State Tournament Admission Prices

	<u>Adult</u>	<u>Student/Senior Cit.</u>
Full Tournament Pass.....	\$18.00	Not Available
Thursday.....	\$6.00	\$4.00
Full Day Friday, prior to 2:00 p.m.....	\$10.00	\$6.00
Friday, after 2:00 p.m.....	\$6.00	\$4.00
Full Day Saturday (includes finals) prior to 3:00 p.m....	\$10.00	\$6.00
Finals Only (Saturday) after 3:00 p.m.....	\$8.00	\$5.00

Pre-sale Tickets/Passes

Pre-sale passes are available to be sold by schools at the same prices listed above. Finals only tickets will not be available for pre-sale. Schools wishing to pre-sell passes should contact the UHSAA office as soon as possible. Tickets may also be purchased on-line using the link found on the UHSAA web-site: www.uhsaa.org

Admission of Teams and Team Personnel

Each participating school will be issued four coaches' floor access wrist bands. One of the four is for the head coach. The head coach of each school is to issue the remaining passes only to certified coaches (see UHSAA By-Laws Article 5). An individual with a coaches' floor access pass is subject to all rules regarding coaches.

Wrestlers competing in the tournament will be stamped as they enter with their team the first time each day. The entire team is to enter at the same time to facilitate check-in. The stamp will admit them for the rest of the day. Wrestlers and coaches will enter the Maverik Center the first time each day through the doors marked "Stair 1", the northern most doors on the west side of the building, adjacent to parking area A14 (see pictures). Bring ID as it may be required. A qualifier check-in list will be used in admitting wrestlers into the building through the team entrance the first time each day. The team entrance will open one hour prior to the weigh-in each day and will close at the beginning of the weigh-in. Re-entry with a wrestler stamp or coaches wrist band the same day will be through the VIP/will call entrance.

All others must have a ticket or pass and will be admitted through the regular patron entrance. School athletic trainers (ATC) will be admitted, if listed on the approved trainers' list, at the VIP/will call entrance (south end, west side). To be listed, certified trainers need to contact Lisa Walker at lisa.walker@nebo.edu.

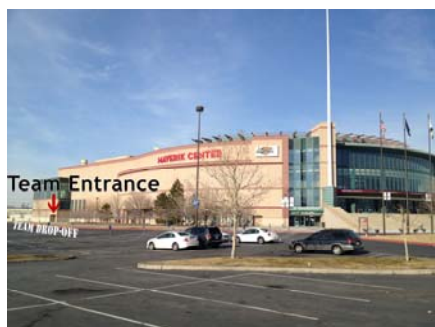

Busses; Team Drop Off; Bus Parking

Buses are to drop off teams at the curb at the team entrance on the west side of the building. The drop off area extends north of the team entrance for about 100 yards, please use the entire drop off area. Busses may then proceed to the bus parking area along far west fence of the parking lot parallel to I-215 or in the auxiliary lot north and east kitty corner to the main Maverik Center property. (see map titled "Bus Parking")

Team/Wrestler Seating

Seating for wrestlers/teams will be in the upper level of the arena, sections 201-226. When teams enter the Maverik Center through the team entrance they will be directed to the upper level. Teams will not be allowed in the lower seating areas, sections 101-126.

Weigh-In; Skin Check

The Weigh-in will take place at the east end of the Golden Corridor . The Golden Corridor is located at the north end of the arena on the upper level (4th floor). The weigh-in will be conducted by weight class according to rule 4-5-3. Wrestlers must report when their weight class is called. Wrestlers will be staged by weight class in the Golden Corridor and then proceed to the weigh-in area. Wrestlers will enter the weigh-in area from the west and exit through the east end of the room. After weighing in, all wrestlers will be subject to a skin check which will occur on the east end of the weigh-in area. An on-site, designated meet physician will be present to rule on suspect skin conditions. Wrestlers should be prepared to present their own physician's statement at this time. As per rule 4-2-4 the on-site designated tournament physician "may over-rule the diagnosis of the appropriate health care professional signing the medical release form..." Wrestlers with scratches or abrasions may be required to cover them for their own protection from potential infection. As per rule 4-2-3 "Covering a communicable condition shall not be considered acceptable and does not make the wrestler eligible to participate." A reminder of the rule regarding the weigh-in: Rule 4-5-7: "All contestants (male and female) shall weigh in wearing a suitable undergarment that completely covers the buttocks and the groin area. Female contestants must also wear a suitable undergarment that covers their breasts..."

Coaches Information

A coaches meeting will be held on the first day of the tournament for each Classification:

4A/5A: Thursday, February 13 2:15 p.m. in the Centennial Room (north end, upper level)

2A/3A: Friday, February 14 8:45 a.m. in the Centennial Room (north end, upper level)

1A: Friday, February 14 3:15 p.m. in the Centennial Room (north end, upper level)

The tournament will be run using Trackwrestling software. Brackets will be updated and available from a link on the Wrestling page of the UHSAA website <http://www.uhsaa.org/winter-sports/wrestling.html> and on the www.trackwrestling.com web-site throughout the tournament.

Please insure proper health guidelines are met and followed at the Region/Division Tournaments.

Wrestlers should be groomed in accordance with rule prior to reporting to the weigh-in.

Medical personnel will check all wrestlers for communicable skin conditions immediately following the State Tournament weigh-in. **A doctor's clearance on the approved form will be required for any questionable skin conditions** subject to rule 4-2-4. The approved skin form is available on the "Wrestling" page of the UHSAA website. <http://www.uhsaa.org/forms/skinform.pdf> Wrestlers will not be allowed to participate without proper clearance.

Coaches should be prepared to provide any medical supplies necessary to cover scratches, abrasions, etc. that are required by designated tournament medical personnel for protection of the wrestler. The UHSAA will not provide supplies to wrestlers, please make preparations. Please bring a school medical kit to the tournament for use with your wrestlers.

Verification of Entries

All entries for the state tournament are to be verified prior to the beginning of the initial weigh-in for the tournament in that classification. The beginning of the initial weigh-in for a classification constitutes the deadline for verification of entries in the state tournament referred to in rule 10-2-1. The beginning of the weigh-in occurs when the first weight class in the classification officially reports to the scales.

Awards

First and second place team trophies will be awarded in all classifications. Six individual places will be scored and six medals awarded in the 2A, 3A, 4A & 5A tournaments. Four places will be scored and awarded medals in the 1A tournament.

No Outside Food Allowed in the Building

There will be no outside food or drink allowed into the Maverik Center. Only those items required by each wrestler and brought in with them through the team entrance will be allowed. **Please advise your wrestlers and fans!**

Cheerleaders

No cheerleaders will be allowed on the floor until final matches in all classifications. Cheer squads are asked to not cheer lower than row 8 in the arena and not behind any scorers' tables during the entire tournament. The UHSAA will only reimburse cheerleaders for the final day of the tournament. Only eight cheerleaders are allowed at mat-side during final matches. **Please remind the cheerleaders that they may not touch the mats while cheering.**

The Following are Strictly Prohibited from the State Wrestling Tournaments:

- a. large school flags, signs or banners of any kind including the type teams run through.
- b. noisemakers of any kind such as whistles, cow bells, horns, pop guns etc.
- c. balloons.
- d. megaphones, either in the stands or used by cheerleaders.
- e. confetti or shredded paper in the stands or on the floor.
- f. fans wearing no shirts (fans must wear shirts at all times)
- g. articles of any type thrown onto the floor.
- h. photographers in the media areas except those representing the UHSAA or credentialed media. No flash units are allowed in media areas or near the floor. Only credentialed media representatives are allowed in media areas.

Please refer to the UHSAA State Tournaments & Meet Support Items list found on page 60 of the UHSAA Handbook for a full list of those things which are allowed and not allowed.

Parking

Parking will be available free of charge in the regular Maverik Center lots.

Bus Parking

Maverik Center Parking Lot Site Diagram

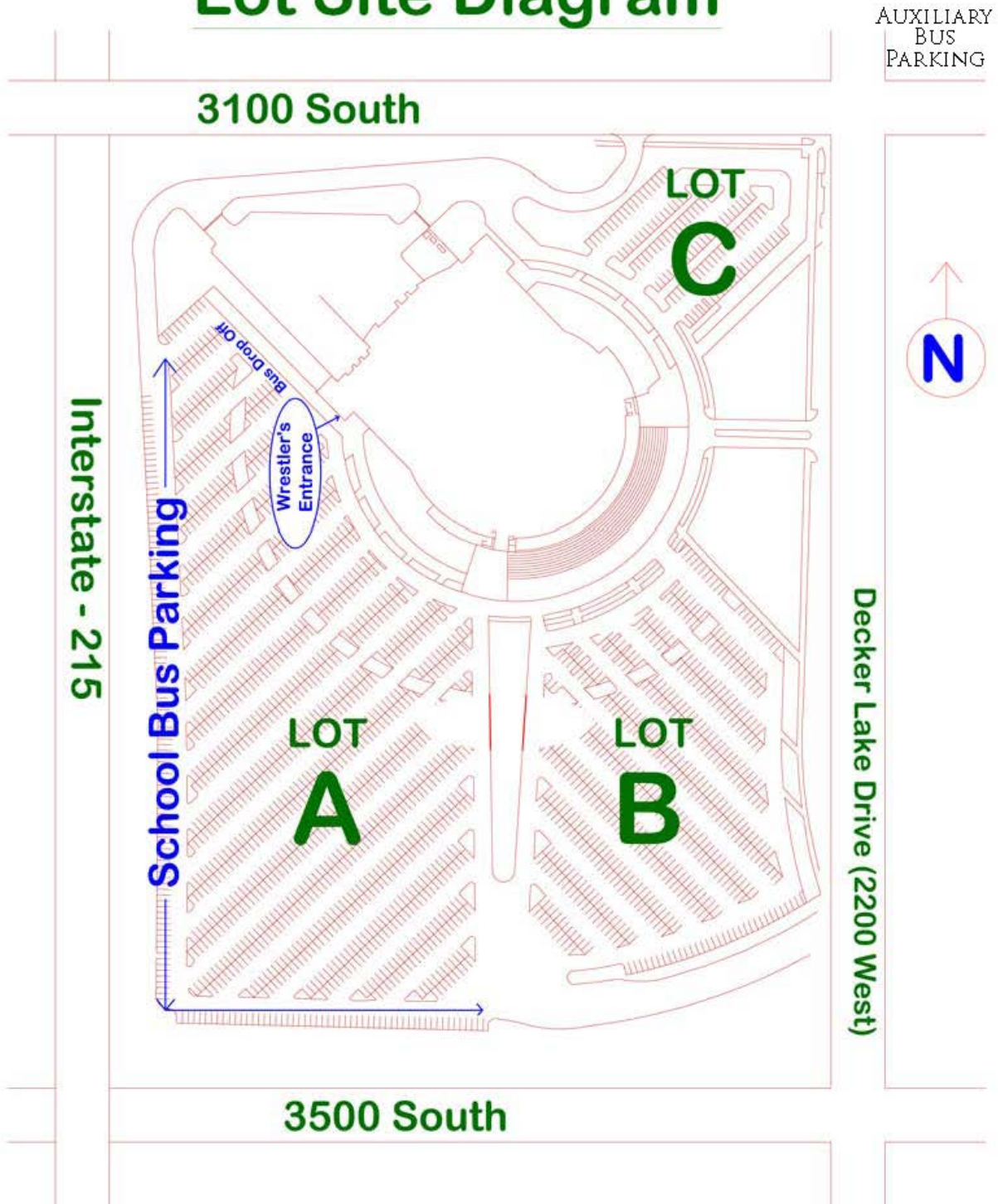

2014 UHSAA State Wrestling Tournaments

Febraury 13, 14, 15, 2014 Maverik Center, West Valley City

updated January 28, 2014

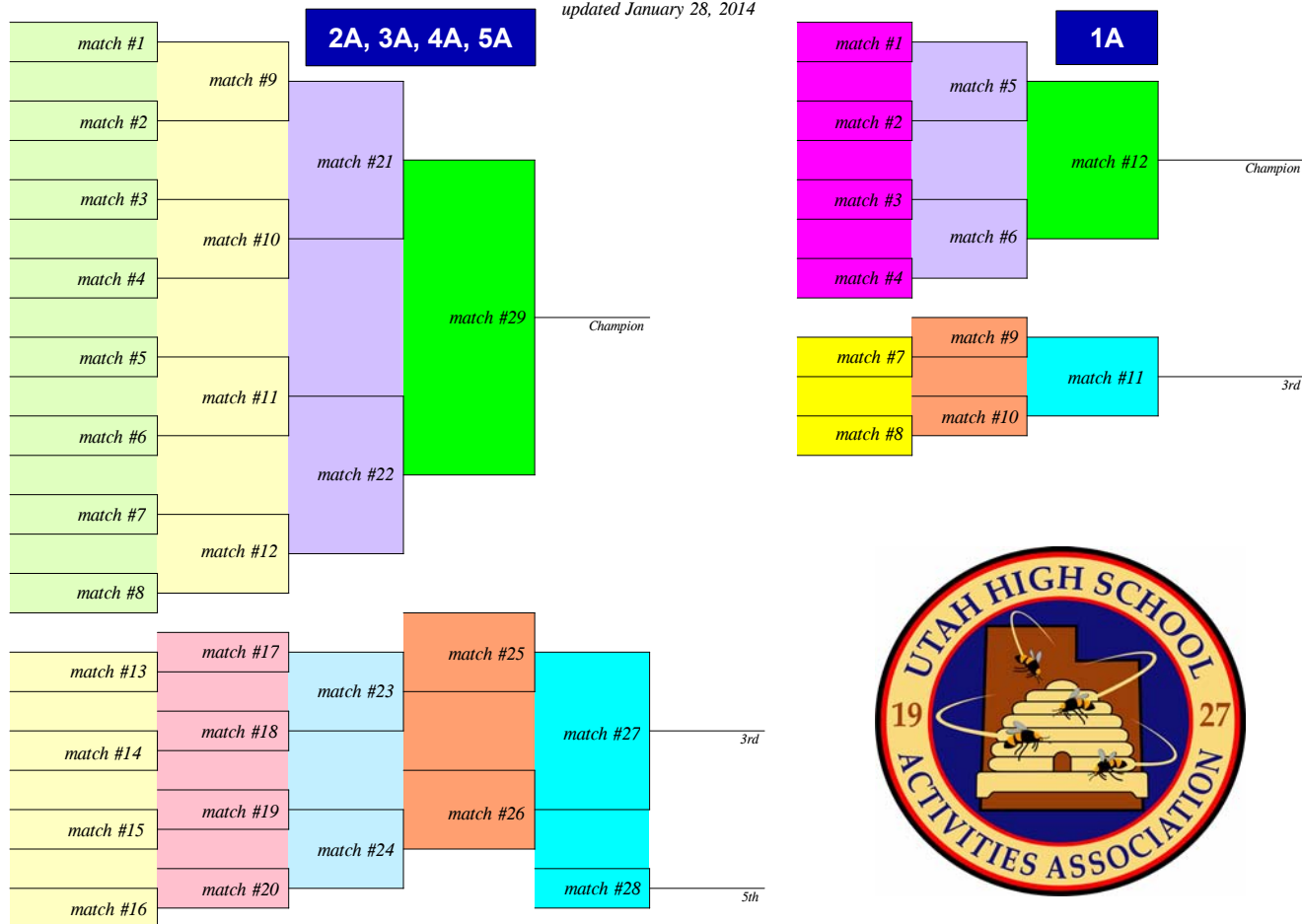

Thursday, February 13, 2014

4A, 5A Weigh-In (east end of Golden Corridor, 4th floor, north end).....	2:00
4A, 5A Coaches Meeting (Centenial Room, 4th floor, south end).....	2:15
4A, 5A Championship Round 1, Matches 1-8 (6 mats each class).....	4:00-6:15
4A, 5A Championship Quarter-Finals, Matches 9-12; Conso. Rd. 1, Matches 13-16 (6 mats each class).....	6:30-8:30

Friday, February 14, 2014

2A, 3A Weigh-In (east end of Golden Corridor, 4th floor, north end).....	8:30
2A, 3A Coaches Meeting (Centenial Room, 4th floor, south end).....	8:45
2A, 3A Championship Round 1, Matches 1-8 (6 mats each class).....	10:30-12:30
2A, 3A Championship Quarter-Finals, Matches 9-12; Conso. Rd. 1, Matches 13-16 (6 mats each class).....	12:45-2:45
4A, 5A Weigh-In.....	1:00
2A,3A,4A,5A Consolation Rd. 2, Matches 17-20 (3 mats each class).....	3:00-5:00
1A Weigh-In (east end of Golden Corridor, 4th floor, north end).....	3:00
1A Coaches Meeting (Centenial Room, 4th floor, south end).....	3:15
1A Wrestle-in Matches, North 4th place vs. South 5th place, single elim. (12 mats).....	5:00-5:10
1A Championship Quarter-Finals, Matches 1-4 (4 mats).....	5:15-6:45
2A,3A,4A,5A Consolation Rd. 3, Matches 23-24 (2 mats each class).....	5:15-6:45
All Classes Championship Semi-Finals, 2A,3A,4A,5A Matches 21-22; 1A Matches 5-6 (2 mats each class).....	7:00-9:00

Saturday, February 15, 2014

1A Weigh-In (east end of Golden Corridor, 4th floor, north end).....	8:30
2A,3A,4A,5A Weigh-In (east end of Golden Corridor, 4th floor, north end).....	9:30
1A Consolation Rd. 1, Matches 7-8 (4 mats).....	10:30-11:15
All Classes Consolation Semi-Finals, 2A,3A,4A,5A Matches 25-26; 1A Matches 9-10 (2 mats each class).....	11:30-1:15
All Classes Consolation Finals, 2A,3A,4A,5A Matches 27-28; 1A Match 11 (2 mats each class).....	1:30-3:00
All Classes Championship Finals, 2A,3A,4A,5A Match 29; 1A Match 12 (1 mat each class).....	4:30-7:00